

ELECTRICAL SYSTEM

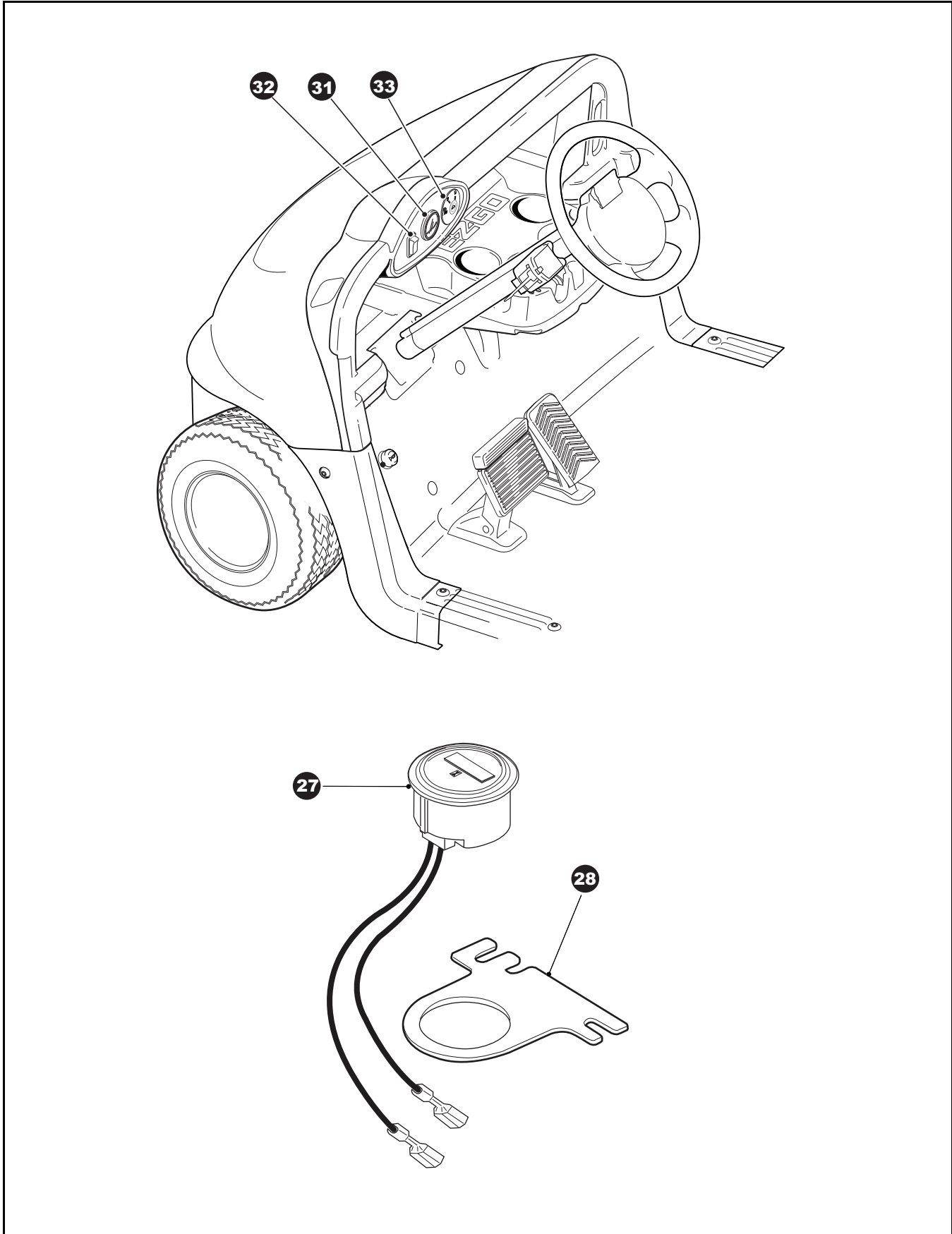

ELECTRICAL SYSTEM

Where applicable, THE USE OF NON UL PARTS WILL VOID ANY UL LISTING.
 When ordering parts, please specify the model and serial number of the product.
 * Indicates a component that is not available as an individual part.
 G** Indicates consult Customer Service Department for additional information.

ITEM	PART NO.	1 2 3 4 5	DESCRIPTION	QTY.
31	604015		FUEL GAUGE	1
32	604019		HEADLIGHT SWITCH.....	1
33	603623		KEY SWITCH.....	1
34				
35	607530		TURN SIGNAL SWITCH KIT (includes items 36 - 38)	1
36	604511		TURN SIGNAL ASSEMBLY.....	1
37	20965G3		COVER	1
38	608771		RUBBER TAPE/INSULATION.....	1
39				
40	607528		HORN ASSEMBLY KIT (includes items 41- 46).....	1
41	01072G01		CLIP	2
42	601476		LOCK NUT, M6 - 1	1
43	601326		BUTTON HEAD TORX BOLT, M6 - 1 X 20	1
44	604196		HORN ASSEMBLY	1
45	604193		HORN BUTTON SWITCH ASSEMBLY	1
46	608397		HORN PLATE	1
47				
48				
49	607445		HEADLIGHT KIT (includes items 50 - 59).....	1
50	607439		HEADLIGHT ASSEMBLY, DRIVER SIDE (includes items 52 - 58)	1
51	607438		HEADLIGHT ASSEMBLY, PASSENGER SIDE (includes items 53 - 59)..	1
52	604452		GASKET, DRIVER SIDE	1
53	74004G01		HEADLIGHT BULB	1
54	604539		TURN SIGNAL BULB.....	1
55	608322		BULB RETAINER	1
56	608328		BUTTON HEAD TORX SCREW, PLASTITE.....	1
57	607487		TURN SIGNAL WIRE HARNESS	1
58	607434		HEADLIGHT RETAINING CLIP.....	4
59	607437		GASKET, PASSENGER SIDE.....	1
60				